

A PROJECT OF YS ASSOCIATE

YS REFFLES PALACE

EXECUTIVE APPARTMENTS

MAIN JINNAH AVENUE 1ST CORNER
PLOT A- 27 BAHRIA TOWN KARACHI

SUITE

3 ROOMS APARTMENTS
ON 3 YEARS EASY INSTALLMENTS

SUPERIOR

5 ROOMS APARTMENTS
ON 3 YEARS EASY INSTALLMENTS

DULUX

5 ROOMS APARTMENTS
ON 3 YEARS EASY INSTALLMENTS

EXECUTIVE

6 ROOMS APARTMENTS
ON 3 YEARS EASY INSTALLMENTS



BAHRIA TOWN
KARACHI



email@imlaakmarketing.com



03316204942 / 03344923277



Office # 209 / 210 Tariq Center, Tariq Road, PECHS block 2, Karachi.



@imlaakmarketing

www.imlaakmarketing.com



A PROJECT OF YS ASSOCIATE

YS REFFLES PALACE

EXECUTIVE APARTMENTS

MAIN JINNAH AVENUE 1ST CORNER
PLOT A- 27 BAHRIA TOWN KARACHI

EXECUTIVE APARTMENTS

SUITE	1200 SQFT
SUPERIOR	1700 SQFT
DULUX	2000 SQFT
EXECUTIVE	2400 SQFT



email@imlaakmarketing.com



03316204942 / 03344923277



Office # 209 / 210 Tariq Center, Tariq Road, PECHS block 2, Karachi.



@imlaakmarketing

www.imlaakmarketing.com

YS REFFLES PALACE

EXECUTIVE APPARTMENTS

MAIN JINNAH AVENUE 1ST CORNER
PLOT A- 27 BAHRIA TOWN KARACHI

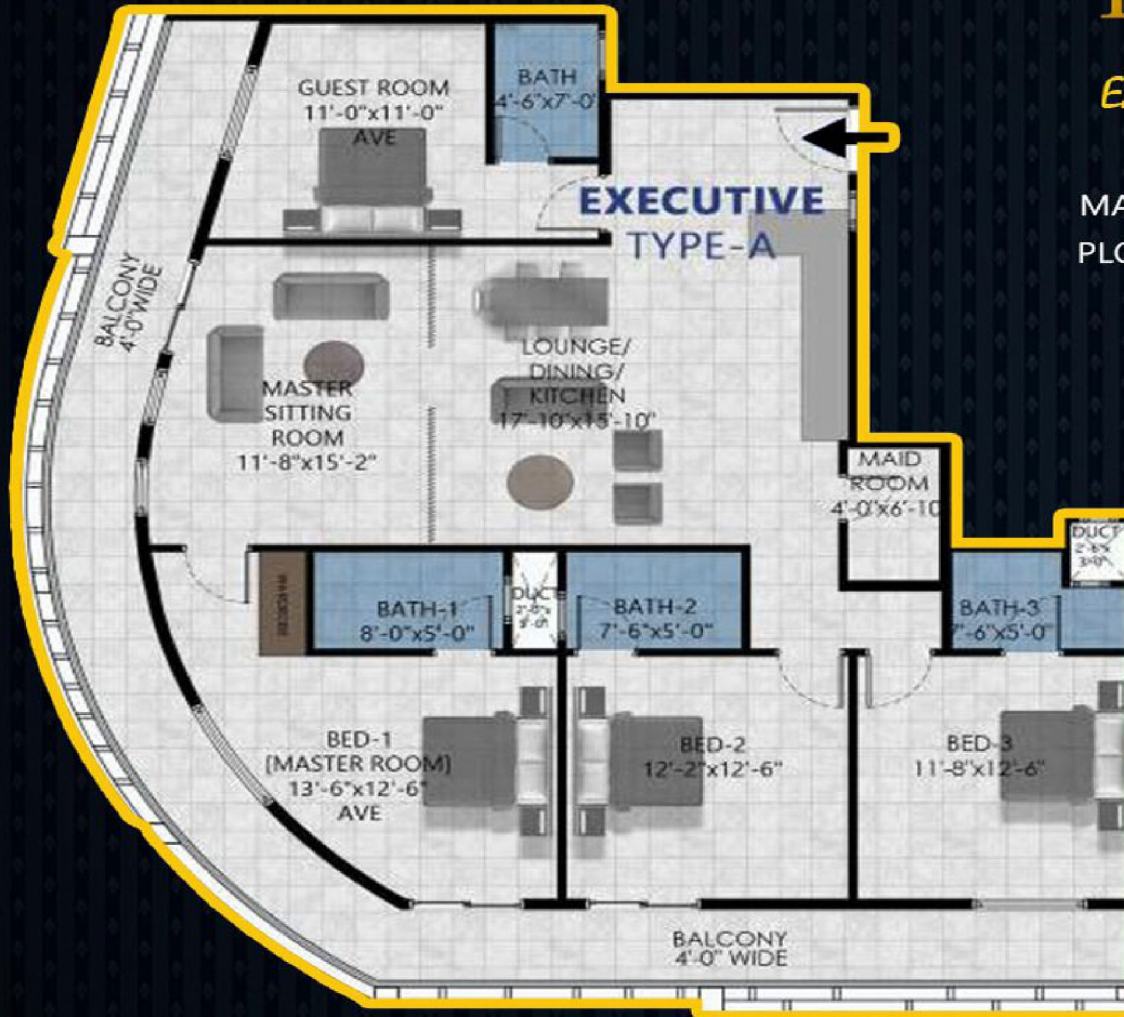

← **EXECUTIVE**



email@imlaakmarketing.com



03316204942 / 03344923277



Office # 209 / 210 Tariq Center, Tariq Road, PECHS block 2, Karachi.



@imlaakmarketing

www.imlaakmarketing.com

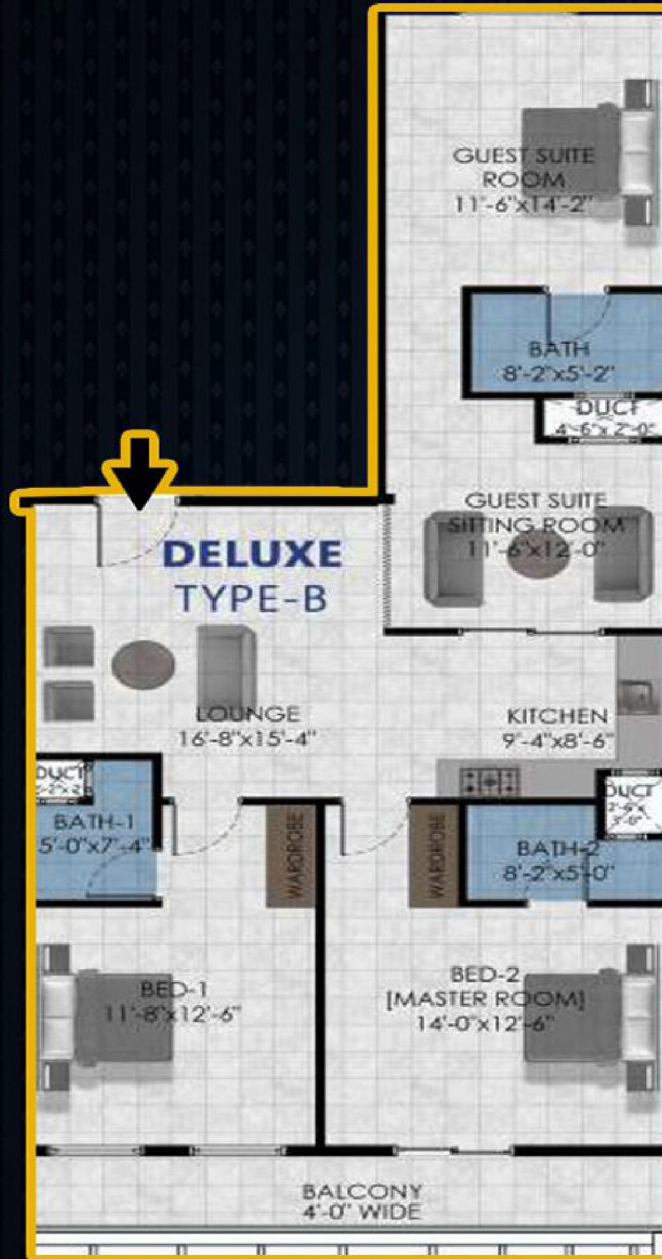

YS REFFLES PALACE

EXECUTIVE APARTMENTS

MAIN JINNAH AVENUE 1ST CORNER
PLOT A- 27 BAHRIA TOWN KARACHI



DELUXE



email@imlaakmarketing.com



03316204942 / 03344923277



Office # 209 / 210 Tariq Center, Tariq Road, PECHS block 2, Karachi.



@imlaakmarketing

www.imlaakmarketing.com

YS REFFLES PALACE

EXECUTIVE APPARTMENTS

MAIN JINNAH AVENUE 1ST CORNER
PLOT A- 27 BAHRIA TOWN KARACHI

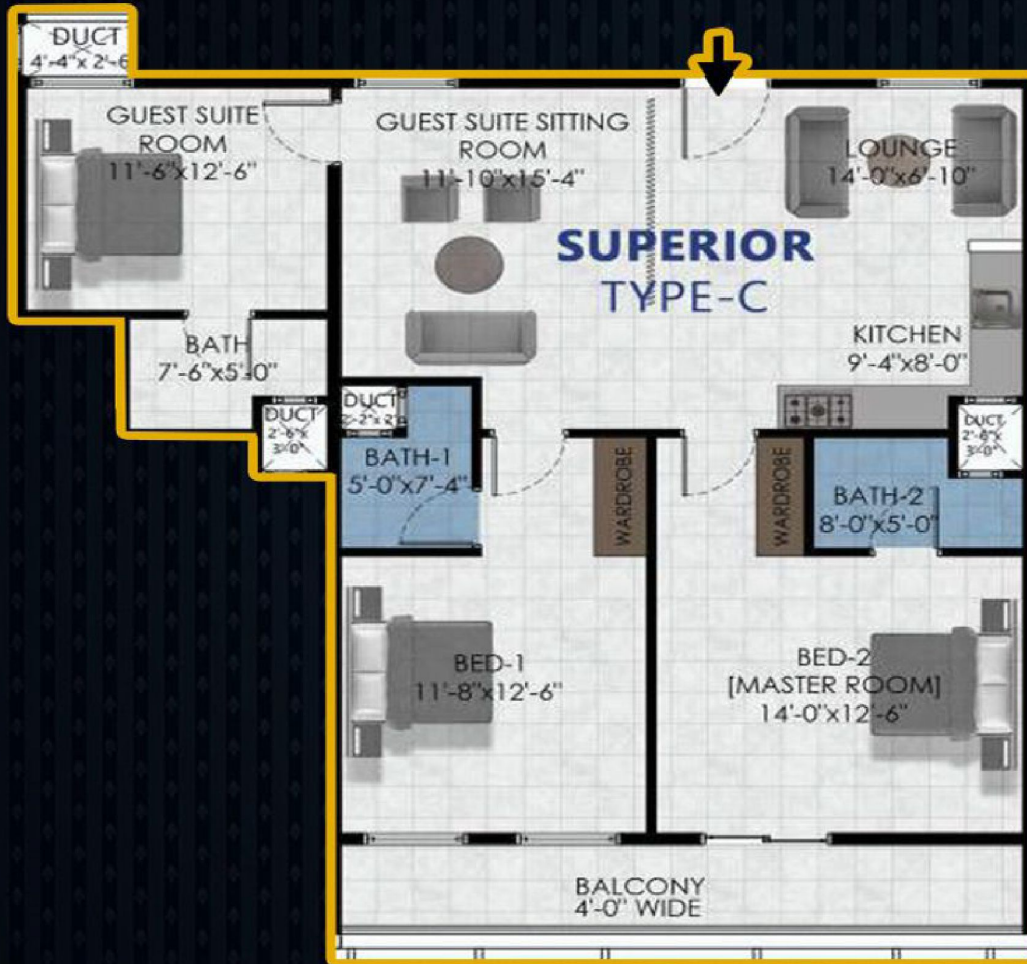

← **SUPERIOR**



email@imlaakmarketing.com



03316204942 / 03344923277



Office # 209 / 210 Tariq Center, Tariq Road, PECHS block 2, Karachi.



@imlaakmarketing

www.imlaakmarketing.com

YS REFFLES PALACE

EXECUTIVE APPARTMENTS

MAIN JINNAH AVENUE 1ST CORNER
PLOT A- 27 BAHRIA TOWN KARACHI

SUITE

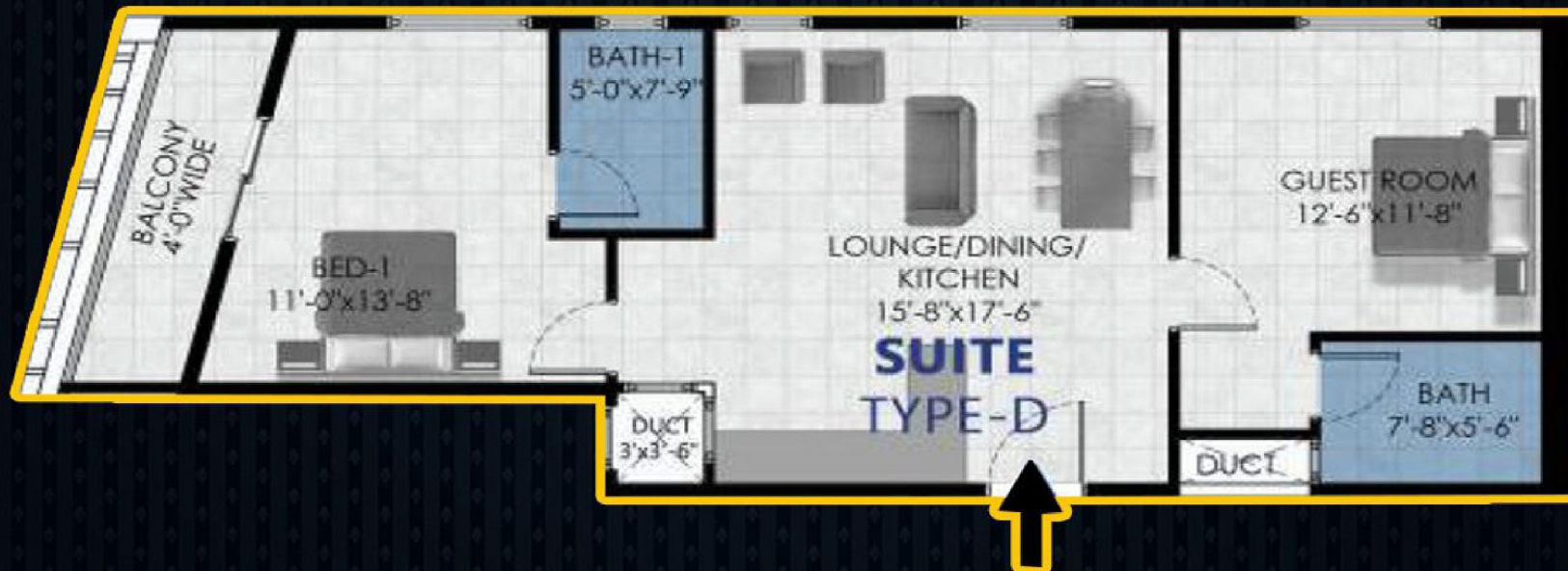

email@imlaakmarketing.com



03316204942 / 03344923277



Office # 209 / 210 Tariq Center, Tariq Road, PECHS block 2, Karachi.



@imlaakmarketing

www.imlaakmarketing.com

A PROJECT OF YS ASSOCIATE



YS REFFLES PALACE

EXECUTIVE APPARTMENTS

MAIN JINNAH AVENUE 1ST CORNER
PLOT A- 27 BAHRIA TOWN KARACHI

EXECUTIVE

6 ROOMS

**36 EASY MONTHLY
INSTALLMENTS**

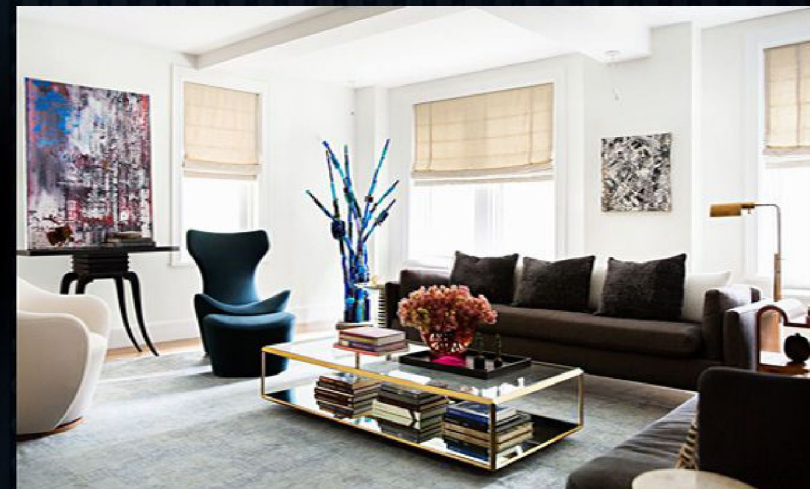

email@imlaakmarketing.com



03316204942 / 03344923277



Office # 209 / 210 Tariq Center, Tariq Road, PECHS block 2, Karachi.



@imlaakmarketing

www.imlaakmarketing.com

A PROJECT OF YS ASSOCIATE



BAHRIA TOWN
KARACHI

YS REFFLES PALACE

EXECUTIVE APPARTMENTS

MAIN JINNAH AVENUE 1ST CORNER
PLOT A- 27 BAHRIA TOWN KARACHI

DULUX

5 ROOMS

**36 EASY MONTHLY
INSTALLMENTS**



email@imlaakmarketing.com



03316204942 / 03344923277



Office # 209 / 210 Tariq Center, Tariq Road, PECHS block 2, Karachi.



@imlaakmarketing

www.imlaakmarketing.com

A PROJECT OF YS ASSOCIATE



YS REFFLES PALACE

EXECUTIVE APPARTMENTS

MAIN JINNAH AVENUE 1ST CORNER
PLOT A- 27 BAHRIA TOWN KARACHI

SUPERIOR

5 ROOMS

**36 EASY MONTHLY
INSTALLMENTS**



email@imlaakmarketing.com



03316204942 / 03344923277



Office # 209 / 210 Tariq Center, Tariq Road, PECHS block 2, Karachi.



@imlaakmarketing

www.imlaakmarketing.com

A PROJECT OF YS ASSOCIATE



YS REFFLES PALACE

EXECUTIVE APPARTMENTS

MAIN JINNAH AVENUE 1ST CORNER
PLOT A- 27 BAHRIA TOWN KARACHI

SUITE

3 ROOMS

**36 EASY MONTHLY
INSTALLMENTS**



email@imlaakmarketing.com



03316204942 / 03344923277



Office # 209 / 210 Tariq Center, Tariq Road, PECHS block 2, Karachi.



@imlaakmarketing

www.imlaakmarketing.com